

Warranty



To receive after sales service, have the followings ready when you contact our branches

1. Name of the product
2. Model number of the product
3. The area of problem
4. Phone number and address at which you can be contacted.

Warranty Card

| | |
|-----------------|--|
| PRODUCT | |
| MODEL | |
| DATE PURCHASED | |
| WARRANTY PERIOD | |
| AGENCY | |
| AGENCY ADDRESS | |

☉ KOCOM Warranties the original purchaser of this product as follows.

- 1) This product is produced under strict quality control and inspection procedures.
- 2) If this product breaks down during proper use as a result of product defect, KOCOM will repair it within one year from date of purchase free of charge.
- 3) The following cases will be subject to charge, even during warranty period:
 - a. Breakdown during transport, or through careless treatment, by consumer.
 - b. Breakdown caused by unauthorized repair, or system modification.
 - c. Breakdown caused by natural disaster or power disorder.

DP-906H-02 | 10. 04

MADE IN KOREA

KOCOM

DOORPHONE

DP-906H USER(INSTALLATION) MANUAL

Features

- Gentle electronic chime bell sound.
- Communication range: ϕ 0.65 mm wire, 300m line
- Can be combined with door opener.
- Consumption : IN LOAD 5W
- Power : AC127V~, 60Hz

Thank you very much for purchasing KOCOM Doorphone. please read this manual thoroughly to ensure correct usage, before operation

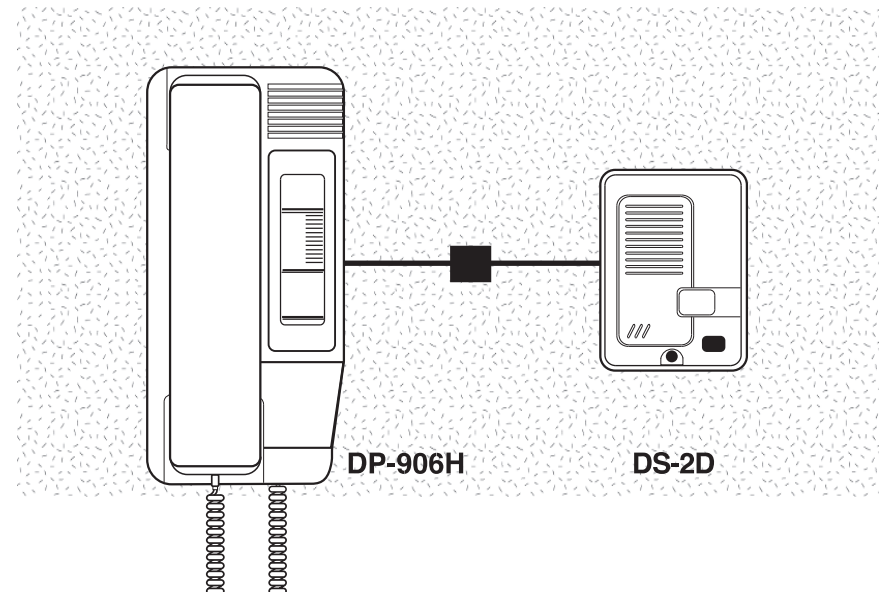

KOREA COMMUNICATIONS CO.,LTD.

Precautions for Operation

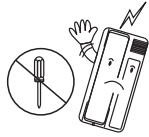

As this device consists of precise electronic components, and high voltage is generated internally, do not attempt to disassemble.



Do not drop Indoor or outdoor station, and avoid strong impact.

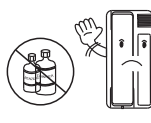

When cleaning, never use wet hands, volatile benzene or paint thinner.



Keep away from humidifier and stove. High temperature and humidity can cause malfunction

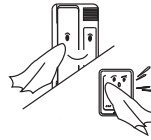

Maintain the product clean by frequently wiping outdoor with soft cloths

Name of Each Part

Indoor Station

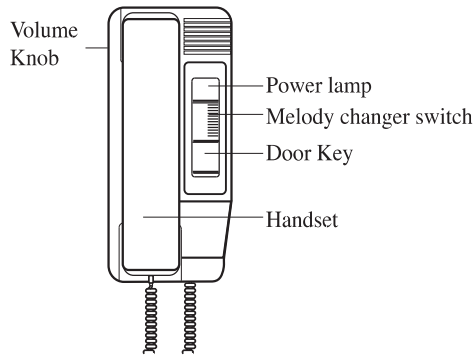

Out door Station

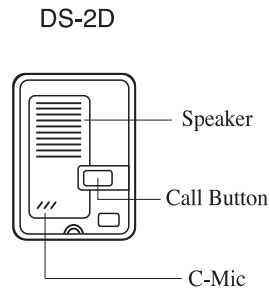

How to operate (Instruction for operating)



When a visitor pushes the outdoor station bell,



The indoor station is ringing.



Pick up the handset and communicate with a visitor. After end of communication, return the handset where it is locked



To release the door, press the "Door Key" button

Wiring Diagram

Connection between master and substation

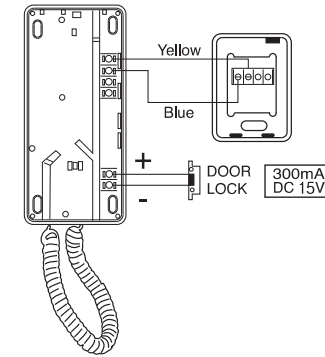

You should connect the wires as shown on the drawing

Installation

Installation of Indoor station

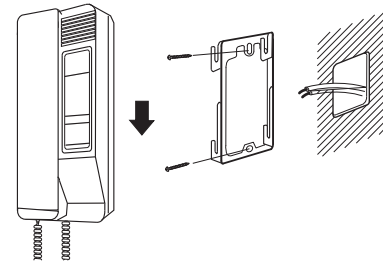

- A- Choose a place on the wall where you want to hang the Indoor station.
- B- Fasten the wall hanger on the wall.
- C- Indoor station can be hung on the wall hanger easily now.

Installation of outdoor station

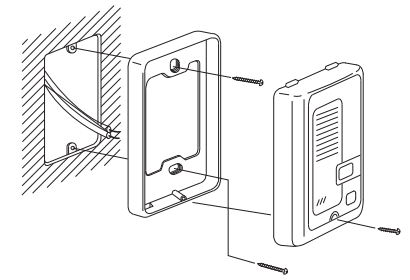

After attaching the body supporter with 2screws, put the Door Camera into the grooves of body supporter, and then fix it with screws.

Specifications

| Description | DP-906H |
|-----------------|---------------------------|
| Electric source | AC127V~, 60Hz |
| Consumption | In use 30mA, Signal 150mA |
| Signal Sound | 4Melody |
| Wiring | 2Wired |
| Range | 300m(∅ 0.65mm) |
| Consumption | IN LOAD 5W |

Component

- Master station for Indoor-use
- Substation for Outdoor-use
- Wall hanger for master station